

EXPLODED VIEW

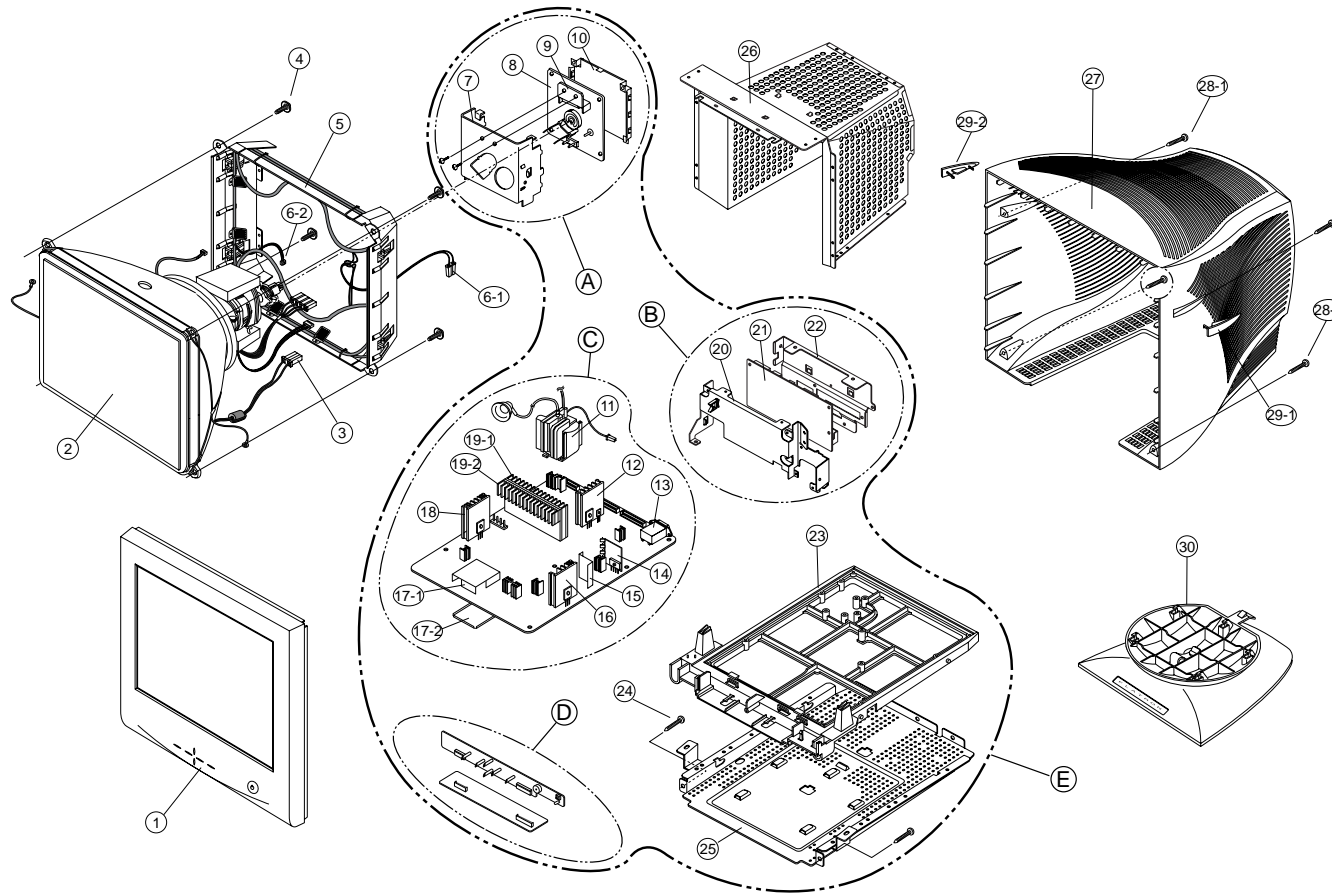

EXPLODED VIEW PARTS LIST

Ref. No.	Part No.	Description	Q'ty	Material
1	3091TKC030A	CABINET ASS'Y, FOR <i>FLATRON 795FT plus</i>	1	LGC GN5001TF UL94-5V
	3091TKC030B	CABINET ASS'Y, FOR <i>未来图 795FT plus</i>	1	
2	2423GC3B41D	CDT, M41QBF423X 02N6LD	1	
3	6868T17004B	CDT EARTH	1	
4	339-002H	SCREW ASS'Y, PHP+5x20+GW18	4	
5	4951TKS035A	METAL FRAME ASS'Y, FOR <i>FLATRON 795FT plus</i>	1	AL (t=1.0)
	4951TKS035B	METAL FRAME ASS'Y, FOR <i>未来图 795FT plus</i>	1	
6-1	6140TC2005A	DEGAUSSING COIL	1	
6-2	6140TC4001C	PURITY COIL	1	
7	4814TKV007A	SHIELD, VIDEO FRONT	1	AL (t=1.2)
8	6871TVH097A	VIDEO PCB ASS'Y	1	
9	4920TKC021A	PLATE, HEAT SINK FOR IC303	1	AL (t=2.0)
10	4814TKV008A	SHIELD, VIDEO REAR	1	SPTC-C (t=0.3)
11	6174T13003E	FBT, Y265434	1	
12	407-T98P	COMPRESS, HEAT SINK FOR Q503, Q507	1	AL (L=60)
13	6200TJB001B	AC SOCKET	1	
14	407-937C	PLATE, HEAT SINK FOR D901	1	TERNE SHEET
15	4920TKK003A	PLATE, HEAT SINK FOR IC902	1	
16	4920TKC016B	COMPRESS, HEAT SINK FOR Q902	1	AL (L=70)
17-1	4814TKK051A	IC SHIELD, TOP	1	SPTC-C (t=0.3)
17-2	4814TKK052A	IC SHIELD, BOTTOM	1	SPTC-C (t=0.3)
18	407-T98W	COMPRESS, HEAT SINK FOR IC601	1	AL (L=65)
19-1	4920TKC003F	COMPRESS, HEAT SINK FOR D714, Q404, Q707	1	AL (120x80)
19-2	4920TKC003E	SUB HEAT SINK FOR D714, Q404, Q707	1	
20	4814TKV024A	FRONT SHIELD, INTERFACE BOARD	1	SBHGI-A (t=1.0)
21	6871TKH004A	PCB ASS'Y, INTERFACE WITH USB	1	
22	4814TKV021A	REAR SHIELD, INTERFACE BOARD	1	SPTC (t=0.5)
23	4810TKM034A	MAIN BRACKET	1	LGC GN5001TF UL94-5V
24	332-102G	SCREW, PTP+4x30	2	
25	4951TKK014A	METAL, BOTTOM SHIELD ASS'Y	1	SBHGI-A (t=1.0)
26	4815TKT006A	TOP SHIELD ASS'Y, FOR <i>FLATRON 795FT plus</i>	1	AL (t=0.6)
	4815TKT006B	TOP SHIELD ASS'Y, FOR <i>未来图 795FT plus</i>	1	
27	3809TKC015A	BACK COVER ASS'Y, FOR <i>FLATRON 795FT plus</i>	1	LGC GN5001TF UL94-5V
	3809TKC015B	BACK COVER ASS'Y, FOR <i>未来图 795FT plus</i>	1	
28	332-102G	SCREW, PTP+4x30	4	
29-1	3550TKK061A	SCREW COVER, RIGHT	1	LGC ABS 303S UL94-V0
29-2	3550TKK061B	SCREW COVER, LEFT	1	LGC ABS 303S UL94-V0
30	3043TKK040A	TILT SWIVEL ASS'Y, FOR <i>FLATRON 795FT plus</i>	1	LGC GN5001TF UL94-5V
	3043TKK040B	TILT SWIVEL ASS'Y, FOR <i>未来图 795FT plus</i>	1	
A	6871TVT098A	PCB ASS'Y, VIDEO TOTAL	1	
B	6871TKT004A	PCB ASS'Y, INTERFACE TOTAL	1	
C	6871TMT084B	PCB ASS'Y, MAIN TOTAL	1	
D	6871TST093B	PCB ASS'Y, CONTROL TOTAL	1	
E	3313T17032B	MAIN TOTAL ASS'Y, FOR <i>FLATRON 795FT plus</i>	1	
	3313T17032D	MAIN TOTAL ASS'Y, FOR <i>未来图 795FT plus</i>	1	